

PRIVATE ACCESS AND UTILITY EASEMENT GRANTED TO FAIRFIELD GREEN VALLEY, INC., OR ITS SUCCESSOR AS OWNER OF THE ADJACENT GOLF COURSE, BY THIS PLAT.

UNSUBDIVIDED

KEY NOTES

- ① 20' PUBLIC SEWER EASEMENT
- ② PRIVATE PEDESTRIAN AND PUBLIC UTILITY EASEMENT
- ③ 10' SIDE YARD SETBACK
- ④ 20' FRONT YARD SETBACK
- ⑤ 10' REAR YARD SETBACK
- ⑥ COMMON AREA "B" (OPEN SPACE) WALLS O.K. IN THIS COMMON AREA AND EASEMENT 20' BUFFERYARD "C" (LOCATED WITHIN ADJACENT GOLF COURSE PER AGREEMENT RECORDED IN DOCKET PAGE _____)
- ⑦ PRIVATE DRAINAGE EASEMENT
- ⑧ 100- YEAR FLOOD PLAIN LIMITS
- ⑨ USE EASEMENT TYPICAL FOR LOTS: 61-85 AND LOTS 98-108

SCALE: 1" = 40'
SEE SHEET 4400-S.
NO. 4

PORTION OF CAMINO DEL SOL TO SERVE THIS SUBDIVISION RECORDED AT DOCKET 9632 AT PAGE 852.

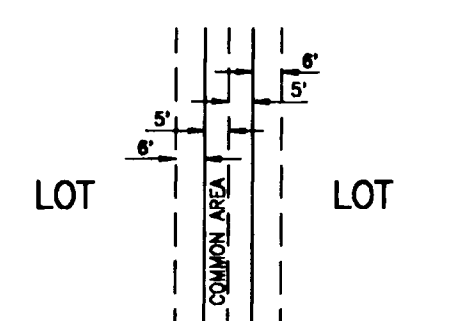

USE EASEMENT TYPICAL FOR LOTS WITH ADJACENT COMMON AREAS
NTS

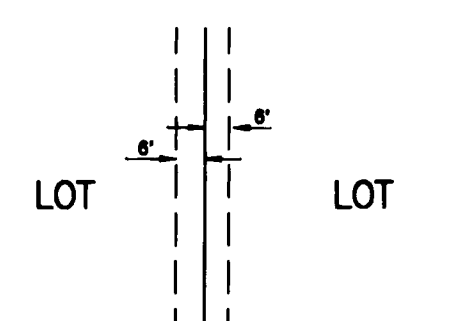

USE EASEMENT TYPICAL FOR ADJACENT LOTS
NTS

ANNOTATED COPY

GENERAL DEPICTION OF REAR YARD AND FRONT YARD EASEMENT AREAS PURSUANT TO THE DECLARATION OF ANNEXATION AND ESTABLISHMENT OF COVENANTS, CONDITIONS, AND RESTRICTION RECORDED AT DOCKET _____ PAGE _____

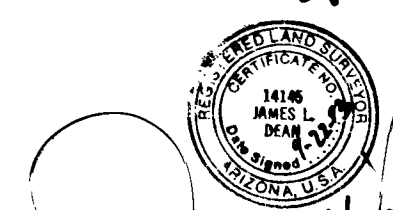

SAN IGNACIO GOLF ESTATES
LOTS 47 - 108 & COMMON AREAS "A", "B"
A PORTION OF THE SAN IGNACIO de la CANOA LAND GRANT
PIMA COUNTY, ARIZONA

	ENGINEERING	800 E. WETMORE ROAD SUITE 110 TUCSON, AZ 85719 (602) 292-2300 FAX (602) 292-1290
	PLANNING	
	SURVEYING	

CO12 - 83 - 19
CO8 - 92 - 43